

SCHEDULE AT-A-GLANCE

MissouriState.edu/ShowcaseSchedule

8:45 a.m.	Check-in GSB Arena concourse	Meet the faculty <i>Session 1</i> GSB Arena concourse	GSB – Great Southern Bank PSU – Plaster Student Union				
9 a.m.			Get 20% OFF at the bookstore + FREE ADMISSION to the Volleyball Bears game at 1 p.m. at Hammons Student Center, and the men's soccer game at 7 p.m. at Betty and Bobby Allison South Stadium!				
9:30 a.m.	Welcome GSB Arena floor						
10 a.m.							
10:30 a.m.		Meet the faculty <i>Session 2</i>	Campus walking tours	Foster Recreation Center tours	Residence hall tours Main entrance of each residence hall	Student Life expo Foster Recreation Center	
11 a.m.	Lunch Blair-Shannon Dining Center/ PSU food court	GSB Arena concourse	+ shuttle tours Leave from GSB Arena. Last tours depart at noon.				
11:30 a.m.							
12 p.m.		Ask Admissions PSU info desk					
12:30 p.m.		Complete a survey and get a free t-shirt					
1 p.m.	Academic open houses Various academic buildings	+ Business as a Bear PSU Ballroom East	Campus walking tours Leave from the Bear Statue in front of the PSU. Last tours depart at 2:30 p.m.			Financial Aid presentation PSU theatre	Education Abroad presentation PSU 313
1:30 p.m.						Residence Life presentation PSU theatre	Spanish language session PSU 315
2 p.m.						FSL presentation PSU 313	Transfer admission presentation PSU 315
2:30 p.m.						Education Abroad presentation PSU 313	Financial Aid presentation PSU theatre
3 p.m.						Spanish language session PSU 315	Residence Life presentation PSU theatre

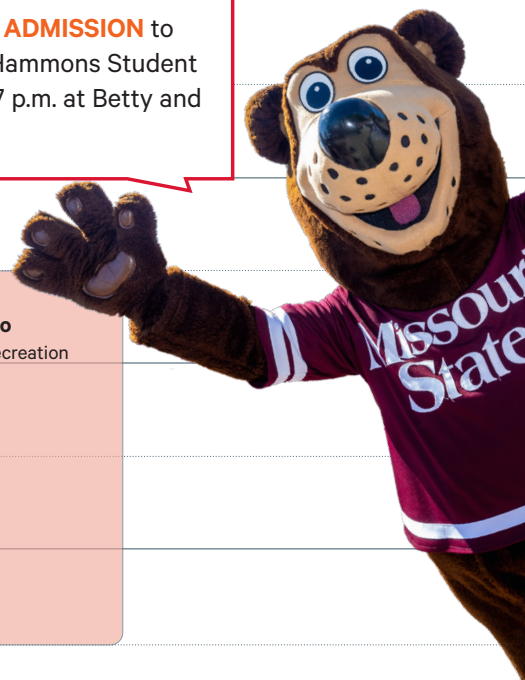

DESCRIPTION OF EVENTS

Join us for a warm Mo State welcome!

You won't want to miss it!

Student Life expo

Explore campus organizations and student support services.

Campus shuttle tours

Learn more about us with a unique 30-minute tour of campus.

Walking tours

Join a current student for a walking tour. Morning tours will be 45-60 minutes, and afternoon tours will be 30-40 minutes.

Foster Recreation Center tours

Explore your place on campus to work out and learn about healthy living. Enter on the south side.

Ask Admissions

Ask questions about the admission process and complete a survey to get a free t-shirt!

Business as a Bear

Ready to be a Bear? Apply for admission in PSU Ballroom East.

Meet the faculty

Meet faculty, advisors and staff from our academic colleges, library and Honors College.

Interest area presentations

Most presentations are offered more than once:

- **Education Abroad presentation**
Learn about the benefits of studying abroad and what to expect during your travels.
- **Financial Aid presentation**
Learn about costs, scholarships, important dates and more.
- **Fraternity and Sorority Life (FSL) presentation**
Learn about the benefits of joining our vibrant FSL community.

- **Residence Life presentation**

Learn about our room layouts, amenities and meal plan options.

- **Spanish language sessions**

Learn about admissions, student life, academics and more in Spanish!

- **Transfer admission presentation**

Learn the basics of the admission process for transfer students.

EXPLORE OUR FACILITIES

These facilities and services will be open for our Showcase guests to visit.

9 a.m. -11 a.m.	Team Store inside GSB Arena Take home some BearWear using your 20% off discount!
11 a.m.-3 p.m.	Missouri State Bookstore Take home some BearWear using your 20% off discount!
10:30 a.m.-2:30 p.m.	Foster Recreation Center This is <i>the</i> place on campus to work out and learn about healthy living. Enter on the south side.
10:30 a.m.-2:30 p.m.	Residence hall tours See where you'll be living as a Bear. Last tour departs at 2 p.m.
11 a.m.-1 p.m.	Lunch in Blair-Shannon Dining Center and PSU food court Students eat for free at Showcase, and families may join using our special event rate.
1 p.m. -3 p.m.	Academic Open Houses See your future classrooms and hear from faculty members about our programs.
9 a.m.-6 p.m.	Meyer Library Explore your new favorite study spot.

STUDENT LIFE EXPO

10:30 a.m.-12:30 p.m., Foster Recreation Center courts

- Army ROTC
- Athletics
- Band
- Bearpawcalypse
- Career Center
- Collegiate DECA
- Computer Services Help Desk
- Education Abroad
- Foreign Language Institute
- Foster Recreation Center
- Fraternity and Sorority Life
- International Programs
- Magers Health and Wellness
- Panhellenic Association
- Paws to the Polls
- Plaster Student Union
- Residence Hall Association
- Residence Life, Housing and Dining Services
- Student Activities Council
- Student Employment
- Student Engagement
- Student Government Association
- Student Resource Center
- The Standard, Missouri State's student-run newspaper
- Traditions Council
- University Ambassadors

MEET THE FACULTY

8:45-9:30 a.m. and 10:30-11:30 a.m.
Great Southern Bank Arena
concourse

College of Business

College of Education

College of Natural and Applied Sciences

Darr College of Agriculture

Graduate College

Honors College

McQueary College of Health and Human Services

MSU Libraries

Reynolds College of Arts, Social Sciences and Humanities

ASK ADMISSIONS + BUSINESS AS A BEAR

12 p.m.-3 p.m., Plaster Student Union info desk

Ask questions and get answers from the admission experts!
Show your completed survey confirmation to receive your free t-shirt.

Ready to apply? Stop by PSU ballroom east!

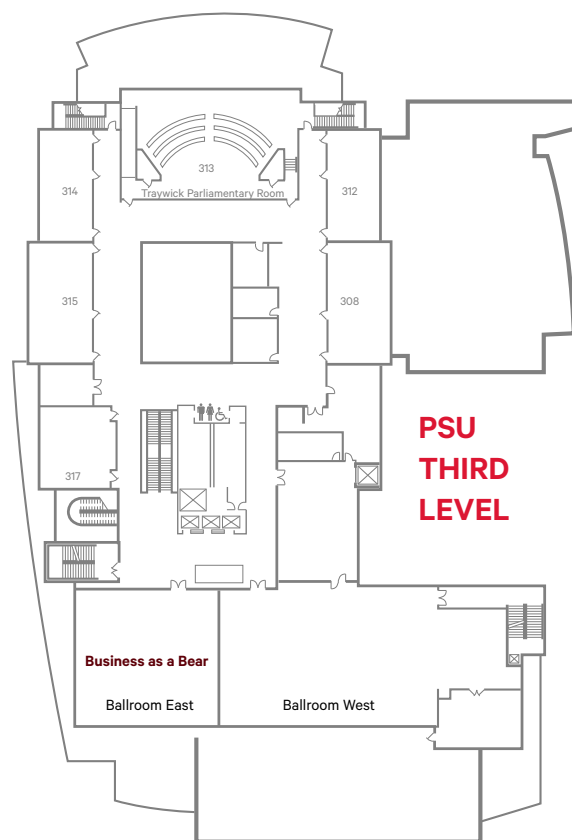
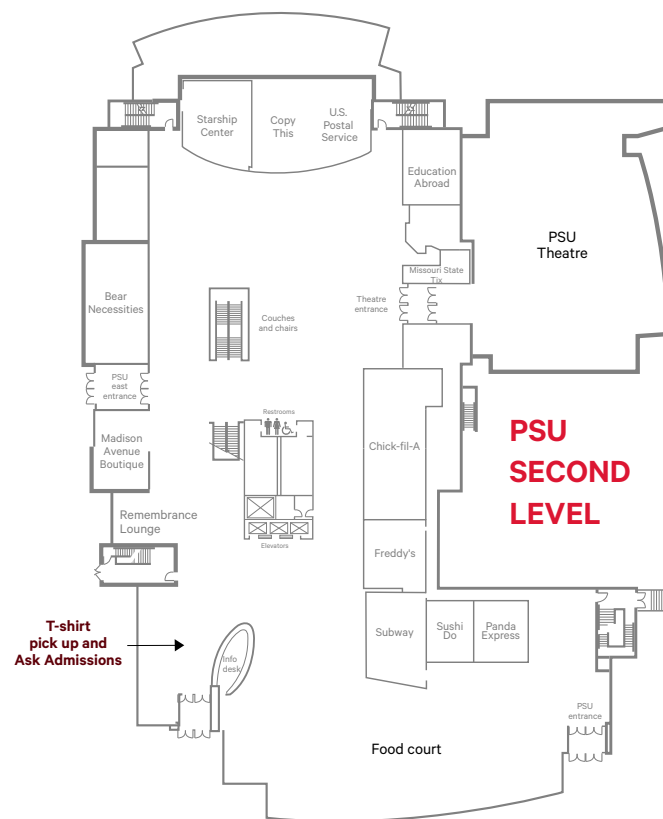

CAMPUS MAP

- Location of key Showcase activities (see Schedule At-A-Glance)
- Academic buildings
- ★ Open buildings
- ⊕ PSU North Shuttle Stop
- Residence halls

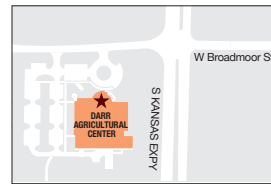

Darr Agricultural Center
2401 S. Kansas Expy.,
Springfield, MO 65807



ACADEMIC OPEN HOUSES

Catch tours and presentations about the areas you're interested in! Sessions are from 1-3 p.m. unless noted.

College of Business

Tours of Glass Hall

Info session 1:30-2:30 p.m.

Glass Hall 108

College of Education

Hill Hall 213

(Enter through front doors.)

College of Natural and Applied Sciences

Blunt Hall tours

Start in Blunt Hall Link for this session.

Darr College of Agriculture

Enter through the main doors of each building:

- Darr Agricultural Center
- Karls Hall
- Pummill Hall

McQueary College of Health and Human Services

- **Athletic Training**
Kampeter Health Sciences Hall 430
- **Anatomy Lab**
Kampeter Health Sciences Hall 369
- **Nursing Anesthesia**
O'Reilly Clinical Health Sciences Center 300, 301, 302
- **Nursing Skills Lab**
O'Reilly Clinical Health Sciences Center 206
- **MCHHS SIM Lab**
O'Reilly Clinical Health Sciences Center 212
- **Health Sciences**
McQueary Family Health Sciences Hall

Reynolds College of Arts, Social Sciences and Humanities

- **Brick City tours**
Shuttles leave from Bronze Bear statue in front of PSU
- **Crime scene investigation demo**
Strong Hall 231
- **Department of music tours**
Enter through main doors of Ellis Hall
- **Siceluff Center for Student Success**
Siceluff Hall 124
- **Strong Hall tours for communication, media, journalism and film**
Meet in Strong Hall 150

MAJORS LIST

Missouri State undergraduate students can choose from more than 90 majors that lead to more than 170 academic options. You can even create an individualized major if you know what you want to study but the specific degree is not offered.

DARR COLLEGE OF AGRICULTURE

Agricultural Business:

Enterprise Management
Finance and Management
Marketing and Sales

Agricultural Communications

Agriculture Education

Animal Science

Environmental Plant Science:

Crop Science
Horticulture
Plant Breeding
and Biotechnology

Equine Science

General Agriculture:*

Agriculture
Agricultural Communication

Hospitality Leadership: \$

Club Management
Food and Beverage
General Operations \$
Lodging
Senior Living Management
Tourism

Natural Resources

Teaching of Agriculture*

Wildlife Conservation and Management

REYNOLDS COLLEGE OF ARTS, SOCIAL SCIENCES AND HUMANITIES

Anthropology

Art:

3-D Studies (Ceramics; Metals
and Jewelry; Sculpture)
Computer Animation
Drawing
New Media
Painting
Photography
Printmaking

Art Education

Communication Studies \$

Criminology and Criminal Justice \$

Culture, Literature and Media: Literature Media

Dance

Design:

Graphic Design
Graphic Design and Illustration
Illustration
Sequential Art

Digital Film and Television Production

Electronic Arts:

Audio Studies
Computer Animation Studies
Interactive New Media Studies
Video Studies

English:

Creative Writing

Literature

English Education

Gerontology

Global Studies

History

History Education

Journalism

Literature

Modern Language:*

(Spanish only) \$
Applied Business
Teacher Certification
Translation
Two Languages

Music:*

Composition
Instrumental Performance
Jazz Performance
Keyboard Performance
Vocal Performance

Music Education:

Instrumental
Vocal/Choral

Musical Theatre**

Philosophy

Political Science

Professional Writing \$

Religious Studies \$

Screenwriting and Film Studies

Sociology \$

Strategic Communication

Teaching of Art*

Teaching of English*

Teaching of History*

Teaching of Modern Language*

Teaching of Music:*

Instrumental
Vocal/Choral

Teaching of Speech and Theatre:*

Communication
Theatre

Theatre

Theatre and Dance:

Acting for Stage and Screen **
Dance
Design, Technology and
Stage Management

Visual Art and Culture:

Art History and Visual Culture
Museum Studies
Studio Art

COLLEGE OF BUSINESS

Accounting \$

Construction Management

Data Analytics

Digital Fashion

and Merchandising:

Fashion Design
Merchandising

Economics \$

Entertainment Management

Entrepreneurship

Finance:

Corporate and Investments \$
Financial Planning
Fintech

General Business \$

Human Resource Management

Information Technology:

Application Development \$
Cybersecurity \$
IT Infrastructure \$

Interior Design

International Business

Management and Leadership

Marketing:

Advertising and Promotion \$
Marketing Management \$
Marketing Research \$
Professional Sales \$

Mechanical Engineering Technology

Risk Management

and Insurance:
Enterprise Risk Management
Insurance

Supply Chain, Logistics and Operations Management \$

COLLEGE OF EDUCATION

Career and Technical Education:

Business Education
Family and Consumer
Sciences

Child and Family

Development: \$

Child Development \$
Child Life
Family Studies
Youth Development \$

Early Childhood Education

Elementary Education

Middle School Education:

Language Arts
Mathematics
Science
Social Sciences

Special Education/ Cross Categorical

MCQUEARY COLLEGE OF HEALTH AND HUMAN SERVICES

Biomedical Sciences:

Anatomy and Physiology
Cell and Molecular Biology
Human Health Sciences

Clinical Laboratory Sciences- Medical Technology**

Communication Sciences

and Disorders:

Audiology
Speech-Language Pathology

Esports Studies

Exercise Science:

Health Studies
Pre-Professional

Health Services:

Clinical Services \$
Health Services \$

Nursing (Completion Program for Registered Nurses) \$

Nursing (Pre-Licensure, Four-Year Program) **

Nutrition and Dietetics

Physical Education*

Psychology \$

Radiography:**

Education
Management
Science

Respiratory Therapy:**

Education
Management
Science

Social Work** \$

Sport and Recreation

Administration

Sports Medicine

COLLEGE OF NATURAL AND APPLIED SCIENCES

Biology:*

Environmental Biology
and Evolution
Microbiology and
Biotechnology
Wildlife Biology

Chemistry:*

Biochemistry
Chemistry

Chemistry Education Pathway

Civil Engineering*

Community and Regional Planning

Computer Science:

Computer Science
Data Science
Software Development

Earth Science

Education Pathway

Electrical Engineering*

Geography and Sustainability*

Geology

Geospatial Sciences

Mathematics:*

Actuarial Mathematics
Applied Mathematics
General Mathematics
Statistics

Mathematics Education*

Mechanical Engineering*

Physics:

Astronomy and Astrophysics
Career Prep Physics
Materials Science

Teaching Prep Physics

Physics Education Pathway

Wildlife Conservation and Management

INTERDISCIPLINARY PROGRAMS

General Studies

Individualized Major

PRE-PROFESSIONAL PROGRAMS

These are not majors.
Instead, they are paths
that prepare you to enter a
graduate degree program.
Many MSU majors will give
you the foundation for
these programs.
Missouri State students
are regularly admitted
to leading schools in all
professional areas.

Pre-Athletic Training

Pre-Chiropractic

Pre-Dentistry

Pre-Engineering

Pre-Law

Pre-Medicine

Pre-Occupational Therapy

Pre-Optometry

Pre-Pharmacy

Pre-Physical Therapy

Pre-Physician

Assistant Studies

Pre-Veterinary Medicine

* Offered as a free-standing
major (e.g., mathematics) or
as a major with a specialization
(e.g., mathematics with an option
in statistics).

** Offered in cooperation with
professional schools. Admission to
Missouri State does not guarantee
admission to the professional
school. Explore undergraduate
catalog for details.

+ These programs are housed in the
department of the subject area.

** A competitive admission program.
Explore undergraduate catalog for
program requirements.

\$ Degrees that may be completed
100% online. For a full list of all
majors, minors, certificates and
graduate programs that are
100% online, explore:
MissouriState.edu/Online

* Offered in cooperation with
Missouri University of Science
and Technology. Contact the
cooperative engineering program
director at **417-837-2315** or
Engineering@MissouriState.edu.